

TRANSPORT DECANTEUR 10 PIEDS



AVANT POSE DES LAMELLES

15/11/2011 09:22 pm

LAMELLES POSEES





DETAIL EVACUATION DES BOUES

VITESSE DE HAZEN POUR 10 m3/h

TUBEdek®



Design of Rectangular Tanks

02/09/2018

Project: ECOTECHNIQUES 10 PIEDS 10 m3/h

Date: 27/04/2012

Flow (Q) [m³/h] 10,00

TUBEdek Type FS41.84

Slope[°] 55

Spec. Projec. Sedimentation Area (A_{spec}) [m²/m³] 7

Tank Length (LB) [m] 1,840

Tank Width (W) [m] 2,250

Module Height (H) [m] 0,900

Number of Parallel Tanks 1,0

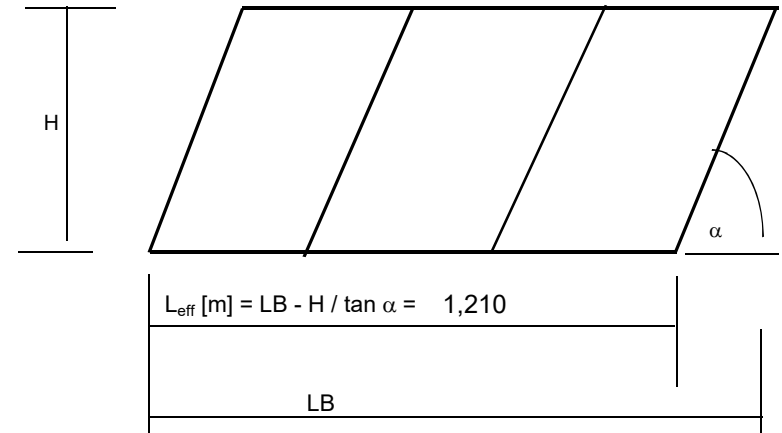

	per tank	total
Effective Base Area ($A_{eff} = L_{eff} * W$) [m²] (Lamella footprint)	2,72	2,72

Base (mirror)velocity : $qA = Q / A_{eff}$ [m/h] 3,67

Total Base Area (A_{ges}) [m²]	4,14	4,14
--	------	------

Hazen velocity: $qP = Q / P$ [m/h] 0,58

Effective Projected Sedimentation Area (P) [m²]	17,15	17,15
--	-------	-------

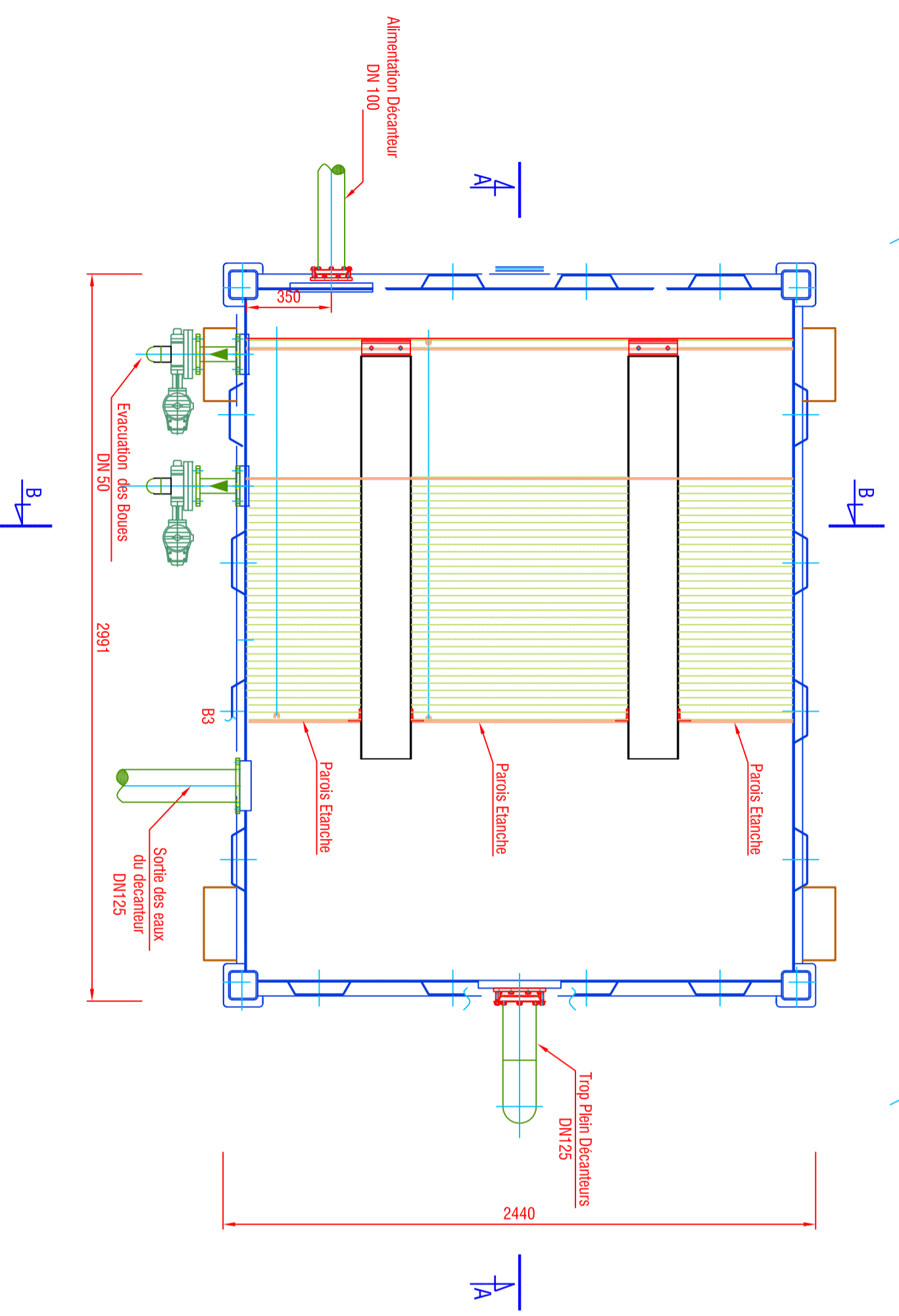
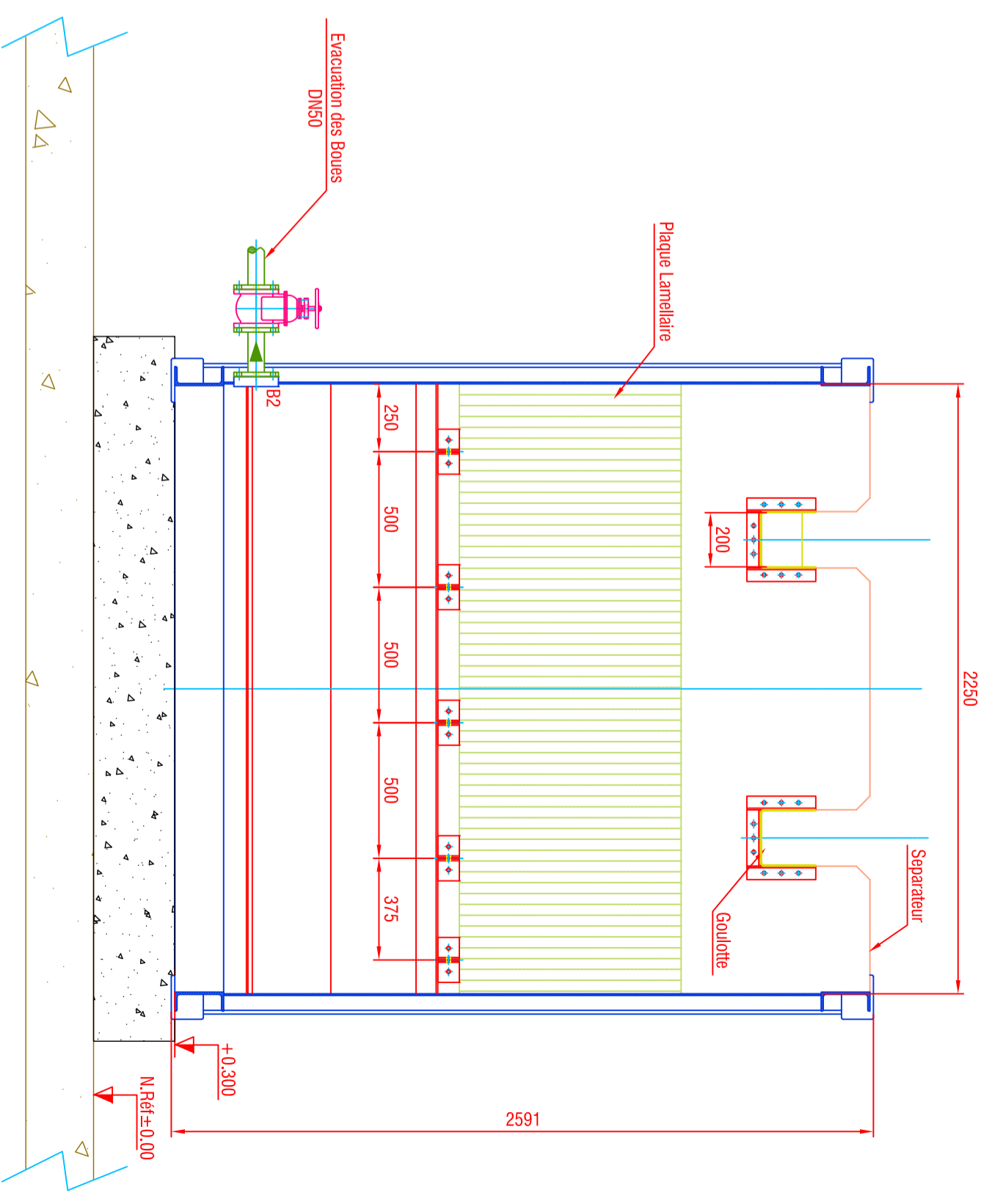
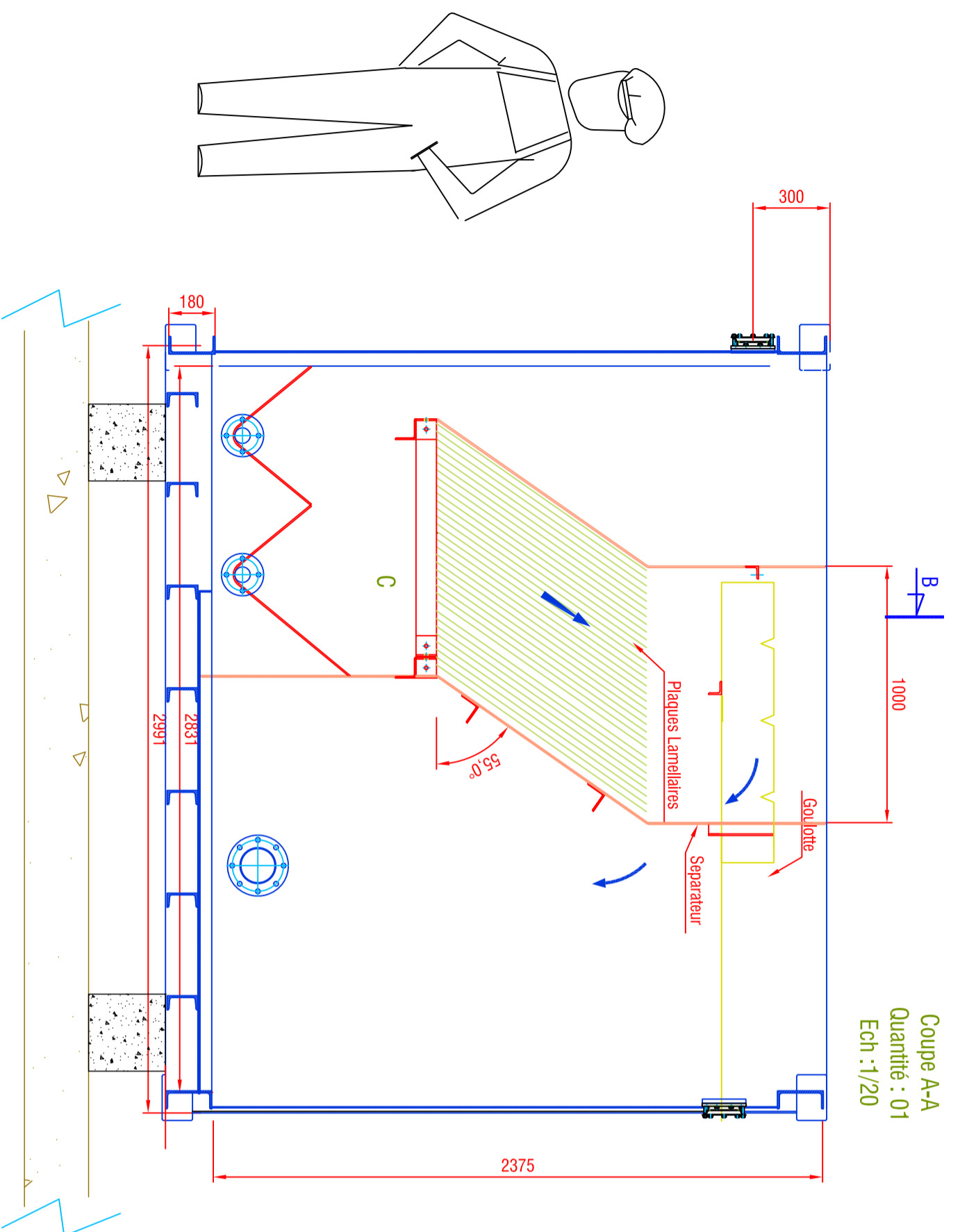

PLAN PROPRIETE de Ecotechniques REPRODUCTION INTERDITE	
DECANTEUR LAMELLAIRE	
10 – m ³ /heure	
Ecotechniques LOCATION TRAITEMENT DES EAUX	
83, Rue Carnot - F 92150 SURESNES Tel. : +331 46 97 08 08 & +336 96 55 67 34 www.ecotechniques.eu - info@ecotechniques.eu	N° Attraitre/Plie N° :
10 PIEUS - TYPE REVERDI www.hydrant.net - info@hydrant.net	Echelle/Scale :
Date :	Plan/Drawing :
20/04/2016	01